

# Internal Gear Driven Pump IPZ 2 - HER 16 Standard with 2,32 ccm/RPM

Default Design (Clockwise Shaft Rotation Viewed)

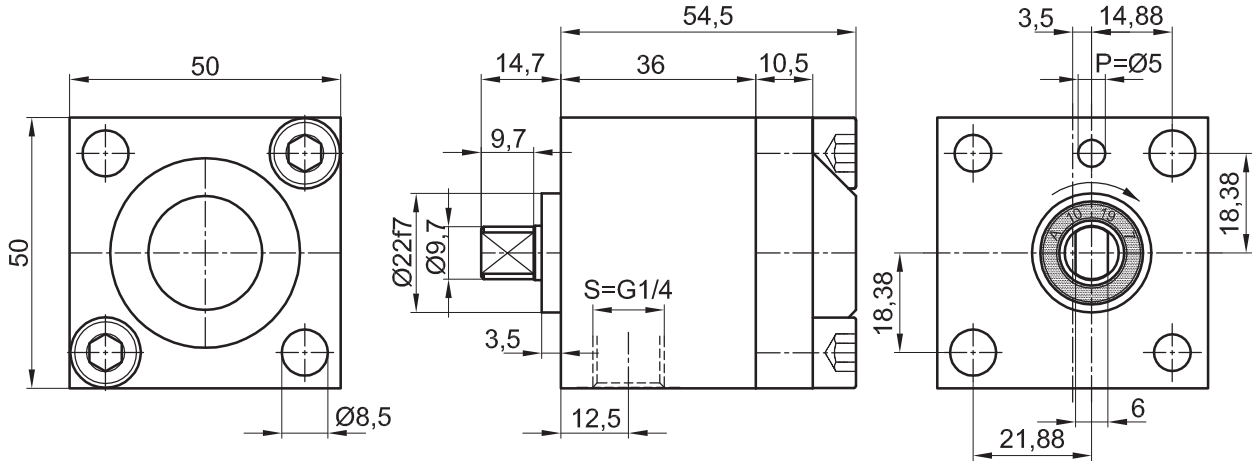

Attachment: DIN 912-M5x45-8:8  
Tightening Torque: 18 Nm

Symbol:



The technical data are based on a viscosity of 46 sq mm/s

ccm/ rpm	Press./bar max.		RPM max.		RPM min.	Mass	Order No.
	P1	P max	Press. P1	Depress.	Press. P1		
2,32	40	80	2000	3000	800	875 g	10021-143

P1 = Working Pressure max. P max. = Pressure Peak

Working Pressure / bar							
Capacity at 1.500 RPM (l/min)							
Power Consumpt./W at 1.500 RPM							
bar	10	20	40	60	80	100	120
l/min	3,4	3,4	3,3	3,3	3,2		
kW	0,12	0,24	0,47	0,70	0,93		

Working Pressure / bar							
Capacity at 3.000 RPM (l/min)							
Power Consumpt./W at 3.000 RPM							
bar	10	20	40	60	80	100	120
l/min	6,9	6,8	6,8	6,7			
kW	0,24	0,47	0,93	1,40			

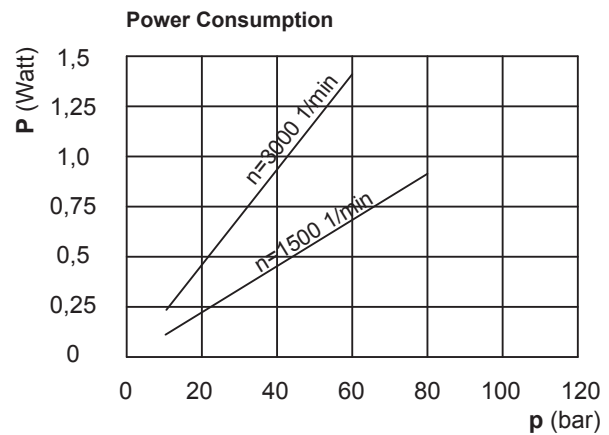
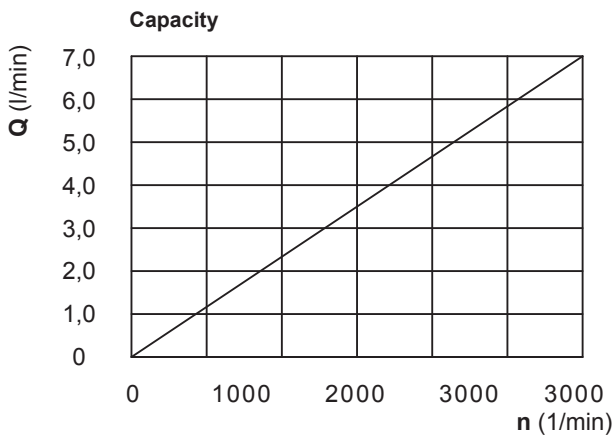

Please specify Pressure, RPM, Temperature, Gain and the Duty Cycle by ordering!



**Jung-Fluidtechnik GmbH**  
Mohrenstrasse 7  
D-76275 Ettlingen

**Phone** +49 (0) 7243-14648  
**Fax:** +49 (0) 7243-17996  
**E-Mail:** info@jung-fluid.de

Data Sheet

**IPZ 2 - HER16**  
subject to modifications